

GURU COLLECTION
guru-usa.com

20
24

waterproof &
shower systems

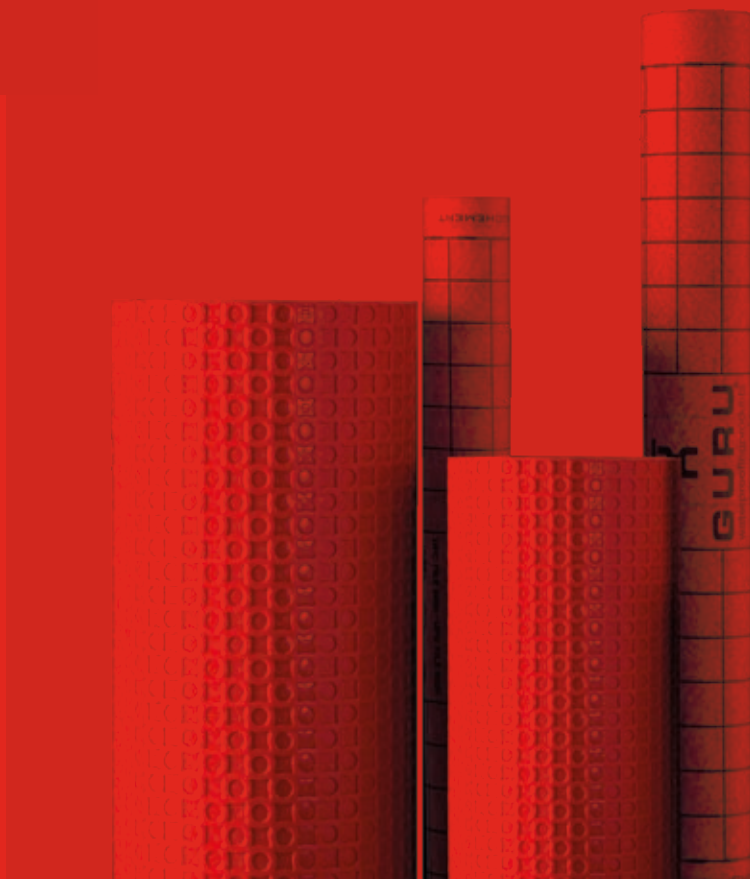

GURU[®]
waterproofingproducts





Our Company	4 - 11
Evo Lite	12 - 13
Evolux Square	14 - 15
Evolux Linear	16 - 17
Revolux Fit to size drain	18 - 19
Evolux Shelf Shower Shelves	20 - 21
Drain Connector Square & Linear	22 - 23
Drain Connector Kit Square & Linear	24 - 25
W-S Heavy Duty Shower Tray Presloped Shower Pans	26 - 29
Kit For Mud Bed Shower Evolux Without Drain	30
Kit For Presloped Shower Superkit Square	31
Water-Stop Waterproofing Membrane	32 - 33
W-S Boards Wall Boards	34
W-S Niche	35
G-Flex Uncoupling Membrane	36 - 37
Water-Stop Accessories	38
XPro Leveling System	39 - 40
Displays	41 - 42





GURU USA

CONTINUOUS EVOLUTION TOWARDS EXCELLENCE

GURU USA L.L.C. is a family business which is consolidated in construction sector with an unblemished reputation and business soundness. GURU has grown with the manufacture and marketing of waterproofing products.

GURU's concern is to incorporate innovative products based on exhaustive research into new proposals for construction solutions. Our attitude leads us to develop reliable products aimed at meeting the expectations of our customers by offering personal and technical support.

GURU is present in four continents with an excellent and professional team who has an extensive experience in waterproofing membranes, Italian shower systems built-in and all kind of accessories for working professional tile fixers. GURU guarantees the highest quality standards according to the criteria provided by the European Union and in compliance with several international certificates that have been performed by external laboratories such as IAPMO, CSTB, KIWA.

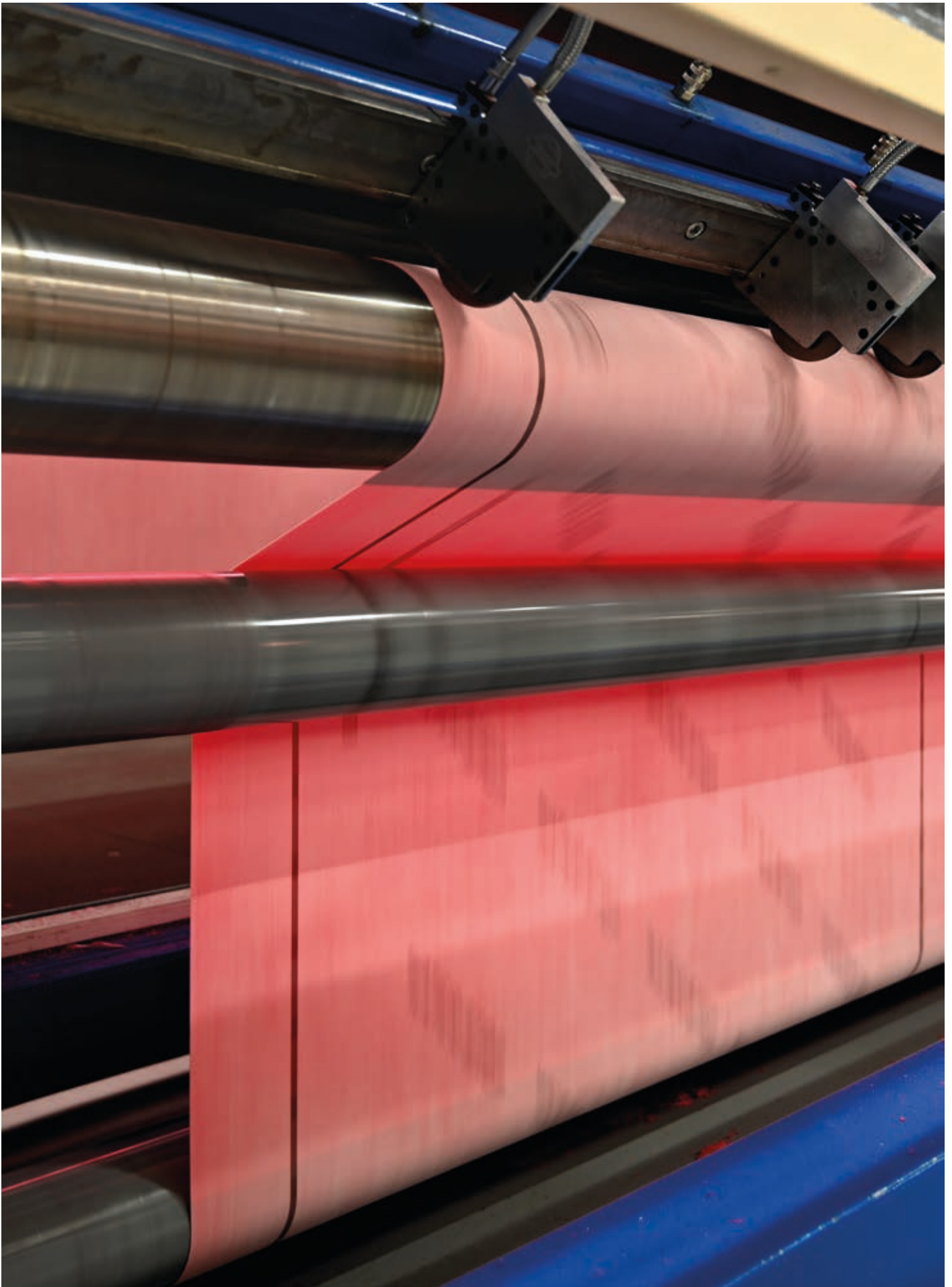



PRODUCTION

MADE IN SPAIN 100%

There are not many PET-EVA sheet manufacturers in the world and we are very proud to be one of them. The only Company that can manufacture up to 3 metres wide and 4 layer membranes.

Since the creation of waterproof products in 2007, our brand has been growing and evolving in the recent years. We have gained access to the final finishing of showers and the need to bring creativity and excellence to our shower grating has arisen.

This is the way that GURU waterproofing products were born—a brand whose products have become the best solution for waterproofing under ceramic tiles in both indoor and outdoor cladding.

Nowadays GURU is a dynamic brand that has gone beyond the company. GURU brings together, evokes, and synthesizes the past, present and future, a brand that opens a mental file, a perfect combination of innovation and tradition.

We design and manufacture our drains to the highest standards and only use the best ABS, manufactured by Repsol.





SUSTAINABILITY

WE CARE FOR THE ENVIRONMENT



RECYCLED: All our products meet the highest demands on recyclability thanks to their unique development. As an example, our drains exceed 95% of recyclability.



LOCALLY PRODUCED GOODS: More than 93% of our suppliers are local, resulting in 100% of the manufactured products in the EU. For instance, our production facilities are located less than 30 miles away.



RESPECT FOR THE ENVIRONMENT: At Guru, we use environmentally friendly packaging materials and have a rigorous recycling policy. Whenever possible, we use packaging made from recycled paper.



CARBON FOOTPRINT: Our product has a lower environmental impact than other systems, thanks to the modern industry practices we employ and the high standards we meet. Moreover, our product is VOC (Volatile Organic Compound)-free.

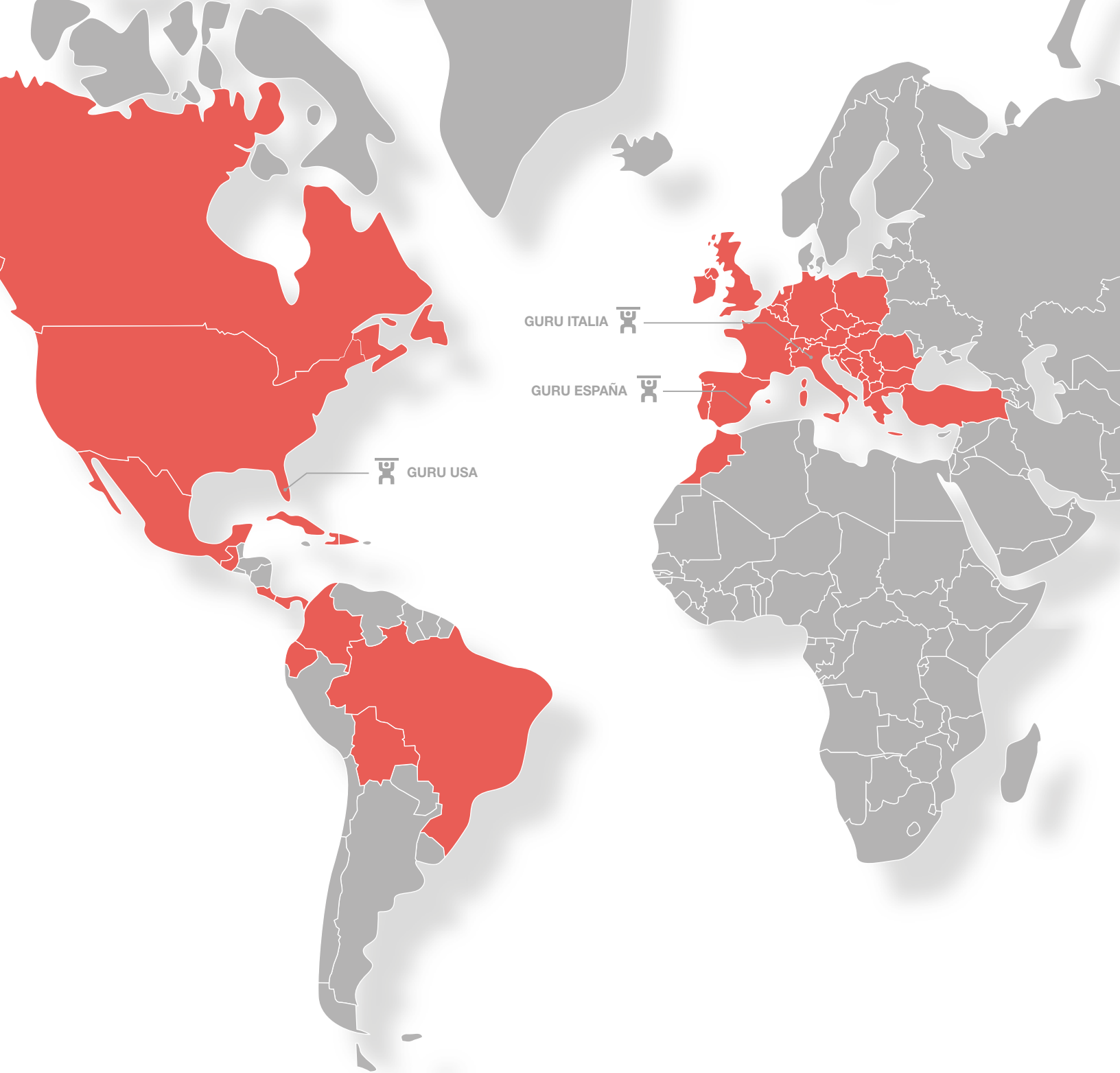



MARKETS

CONTINUOUSLY DEVELOPING TOTAL QUALITY

The range of products crafted by GURU USA not only ensures the highest quality in the market but also provides diverse options, allowing you to find precisely what you need in every market and situation.

We have positioned ourselves as leaders in the waterproofing sector, leveraging the latest technology and our highly qualified team.

EVO LITE DRAINS



Beautiful stainless steel drain with ABS base and hair strainer. EVO Lite, EVO Value!



PLUS BRUSHED
NEW FINISH



PLUS NERO
NEW FINISH



PLUS POLISHED
NEW FINISH



PLUS GOLD
NEW FINISH



PLUS BRONZE
NEW FINISH

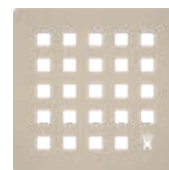

**PLUS NICKEL
CHAMPAGNE**
NEW FINISH



PLUS WHITE
NEW FINISH

REF.	DESCRIPTION	MSRP
IDU7011	EVO LITE PLUS BRUSHED	\$ 90.00
IDU7012	EVO LITE PLUS NERO	\$ 90.00
IDU7013	EVO LITE PLUS POLISHED	\$ 105.00
IDU7014	EVO LITE PLUS GOLD	\$ 105.00
IDU7015	EVO LITE PLUS BRONZE	\$ 105.00
IDU7016	EVO LITE PLUS NICKEL CHAMPAGNE	\$ 105.00
IDU7017	EVO LITE PLUS WHITE	\$ 90.00



**SPRING NICKEL
CHAMPAGNE**

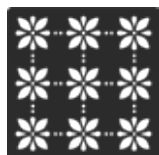

SPRING NERO
NEW FINISH



**SQUARE NICKEL
CHAMPAGNE**



SQUARE NERO
NEW FINISH



**SPIGA NICKEL
CHAMPAGNE**

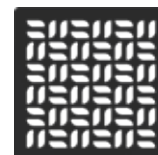

SPIGA NERO
NEW FINISH

REF.	DESCRIPTION	MSRP
IDU7005	EVO LITE SPRING NICKEL CHAMPAGNE	\$ 106.00
IDU7006	EVO LITE SPRING NERO	\$ 92.00
IDU7007	EVO LITE SQUARE NICKEL CHAMPAGNE	\$ 106.00
IDU7008	EVO LITE SQUARE NERO	\$ 92.00
IDU7009	EVO LITE SPIGA NICKEL CHAMPAGNE	\$ 106.38
IDU7010	EVO LITE SPIGA NERO	\$ 92.00



DRAIN

Lowest height drain 5/16" made of premium stainless steel.

ADAPTER

A push-in resilient connection for the most common clamping ring shower drains.

HAIR STRAINER

Premium ABS hair-strainer included.

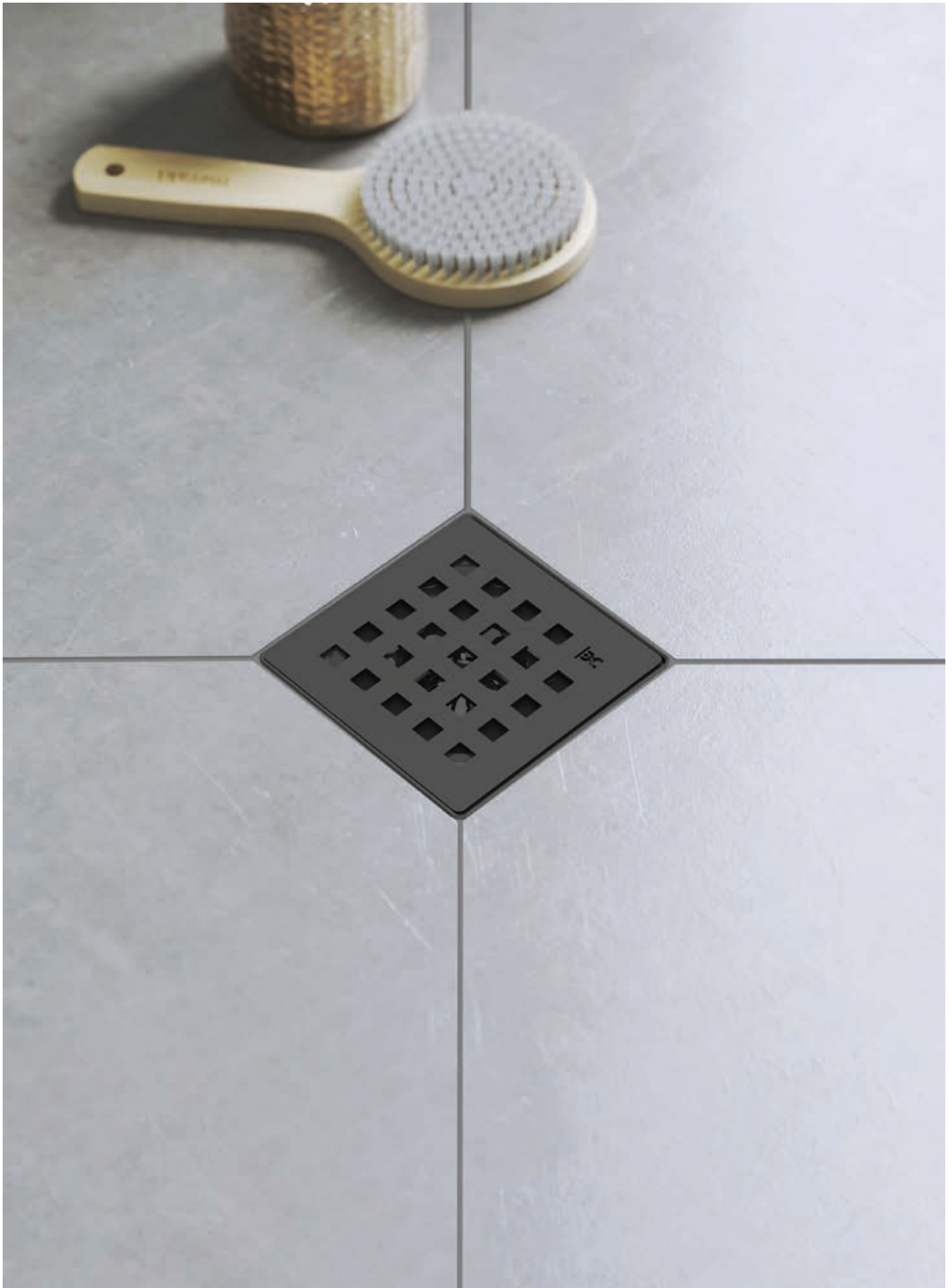

EVOLUX SQUARE DRAINS



316 Marine Grade Stainless Steel square drain with a unique clamping connection to fit any pipe connection.



LISA



PLUS



INTEGRA

Tileable grate!



LISA ANTIQUE



PLUS ANTIQUE



LISA NERO
NEW FINISH

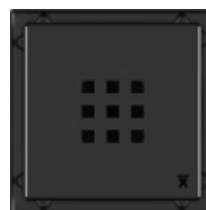

PLUS NERO
NEW FINISH



GOLD

REF.	DESCRIPTION	SIZE	MODEL	MSRP
IDU3104	SQUARE DRAIN & STRAINER	4½"	LISA	\$ 139.00
IDU3204	SQUARE DRAIN & STRAINER	4½"	PLUS	\$ 139.00
IDU3504	SQUARE DRAIN & STRAINER	4½"	INTEGRA	\$ 158.00
IDU4145	SQUARE DRAIN & STRAINER	4½"	LISA ANTIQUE	\$ 162.50
IDU4245	SQUARE DRAIN & STRAINER	4½"	PLUS ANTIQUE	\$ 162.50
IDU5145	SQUARE DRAIN & STRAINER	4½"	LISA NERO	\$ 135.00
IDU5245	SQUARE DRAIN & STRAINER	4½"	PLUS NERO	\$ 135.00
IDU6104	SQUARE DRAIN & STRAINER	4½"	GOLD	\$ 162.50

Shower drain in compliance with **ASME A112.18.2-2015/ CSA B125.2-15.**

Product accepted by IAPMO



DRAIN

Low profile drain 3/8" height made of marine grade stainless steel, 16 gauges.

ADAPTER

A push-in resilient connection for the most common clamping ring shower drains.

HAIR STRAINER

Premium ABS hair-strainer included.





316 Marine Grade Stainless Steel linear drain with a unique clamping connection to fit any pipe connection.

REF.	DESCRIPTION	SIZE	MODEL	MSRP
IDU3116	LINEAR DRAIN & STRAINER	16"	LISA	\$ 220.00
IDU3124	LINEAR DRAIN & STRAINER	24"	LISA	\$ 230.00
IDU3128	LINEAR DRAIN & STRAINER	28"	LISA	\$ 249.00
IDU3136	LINEAR DRAIN & STRAINER	36"	LISA	\$ 310.00
IDU3148	LINEAR DRAIN & STRAINER	48"	LISA	\$ 340.00
IDU3160	LINEAR DRAIN & STRAINER	60"	LISA	\$ 395.00
IDU3216	LINEAR DRAIN & STRAINER	16"	PLUS	\$ 220.00
IDU3224	LINEAR DRAIN & STRAINER	24"	PLUS	\$ 230.00
IDU3228	LINEAR DRAIN & STRAINER	28"	PLUS	\$ 249.00
IDU3236	LINEAR DRAIN & STRAINER	36"	PLUS	\$ 310.00
IDU3248	LINEAR DRAIN & STRAINER	48"	PLUS	\$ 340.00
IDU3260	LINEAR DRAIN & STRAINER	60"	PLUS	\$ 395.00
IDU3516	LINEAR DRAIN & STRAINER	16"	INTEGRA	\$ 248.00
IDU3524	LINEAR DRAIN & STRAINER	24"	INTEGRA	\$ 265.00
IDU3528	LINEAR DRAIN & STRAINER	28"	INTEGRA	\$ 275.00
IDU3536	LINEAR DRAIN & STRAINER	36"	INTEGRA	\$ 349.00
IDU3548	LINEAR DRAIN & STRAINER	48"	INTEGRA	\$ 375.00
IDU3560	LINEAR DRAIN & STRAINER	60"	INTEGRA	\$ 415.00
IDU4128	LINEAR DRAIN & STRAINER	28"	ANTIQUE	\$ 335.00
IDU4136	LINEAR DRAIN & STRAINER	36"	ANTIQUE	\$ 375.00
IDU5124	LINEAR DRAIN & STRAINER	24"	LISA NERO	\$ 318.00
IDU5128	LINEAR DRAIN & STRAINER	28"	LISA NERO	\$ 325.00
IDU5136	LINEAR DRAIN & STRAINER	36"	LISA NERO	\$ 356.00
IDU5224	LINEAR DRAIN & STRAINER	24"	PLUS NERO	\$ 318.00
IDU6128	LINEAR DRAIN & STRAINER	28"	GOLD	\$ 345.00
IDU6136	LINEAR DRAIN & STRAINER	36"	GOLD	\$ 395.00
IDU3324	LINEAR DRAIN & STRAINER	24"	ZEN	\$ 320.00
IDU5324	LINEAR DRAIN & STRAINER	24"	ZEN NERO	\$ 325.00
IDU8136	LINEAR DRAIN & STRAINER	36"	ARTS	\$ 425.00
IDU9128	LINEAR DRAIN & STRAINER	28"	GLASS	\$ 379.50
IDU9136	LINEAR DRAIN & STRAINER	36"	GLASS	\$ 434.50



LISA



PLUS



INTEGRA (TILEABLE GRATE)



LISA ANTIQUE



LISA NERO NEW FINISH



PLUS NERO NEW FINISH



GOLD



ZEN



ZEN NERO NEW FINISH



ARTS (100 PCS MIN.)



TEMPERED GLASS



includes

DRAIN

Low profile drain 3/8" height made of marine grade stainless steel, 16 gauges.

ADAPTER

A push-in resilient connection for the most common clamping ring shower drains.

HAIR STRAINER

Premium ABS hair-strainer included.





Revolut offers a luxurious shower experience with a focus on customization, elegance, and convenience. It introduces a customizable shower channel, allowing you to tailor the length to fit your space perfectly.

Installation is hassle-free, ensuring a quick setup. Crafted from premium 6063-T6 aircraft grade aluminum, Revolut promises durability and sophistication.

With five captivating finishes to choose from, it elevates your bathroom's aesthetics. The high drain evacuation flow ensures superior water drainage and cleanliness.

Upgrade to Revolut for innovation, style, and functionality, making every shower a masterpiece of luxury.

REF.	DESCRIPTION	FINISH	SIZE	MSRP
IDU1148	REVOLUX CURVE	CHROME MATE	48"	\$ 238.00
IDU1248	REVOLUX CURVE	BLACK	48"	\$ 238.00
IDU1348	REVOLUX CURVE	NICKEL CHAMPAGNE	48"	\$ 238.00
IDU1448	REVOLUX CURVE	GOLD	48"	\$ 238.00
IDU1548	REVOLUX CURVE	ROSE	48"	\$ 238.00

REF.	DESCRIPTION	FINISH	SIZE	MSRP
IDU1178	REVOLUX CURVE	CHROME MATE	78"	\$ 385.00
IDU1278	REVOLUX CURVE	BLACK	78"	\$ 385.00
IDU1378	REVOLUX CURVE	NICKEL CHAMPAGNE	78"	\$ 385.00
IDU1478	REVOLUX CURVE	GOLD	78"	\$ 385.00
IDU1578	REVOLUX CURVE	ROSE	78"	\$ 385.00



REF.	DESCRIPTION	FINISH	SIZE	MSRP
IDU2148	REVOLUX CAVITY	CHROME MATE	48"	\$ 238.00
IDU2248	REVOLUX CAVITY	BLACK	48"	\$ 238.00
IDU2348	REVOLUX CAVITY	NICKEL CHAMPAGNE	48"	\$ 238.00
IDU2448	REVOLUX CAVITY	GOLD	48"	\$ 238.00
IDU2548	REVOLUX CAVITY	ROSE	48"	\$ 238.00

REF.	DESCRIPTION	FINISH	SIZE	MSRP
IDU2178	REVOLUX CAVITY	CHROME MATE	78"	\$ 385.00
IDU2278	REVOLUX CAVITY	BLACK	78"	\$ 385.00
IDU2378	REVOLUX CAVITY	NICKEL CHAMPAGNE	78"	\$ 385.00
IDU2478	REVOLUX CAVITY	GOLD	78"	\$ 385.00
IDU2578	REVOLUX CAVITY	ROSE	78"	\$ 385.00





FIT TO SIZE

Thanks to its trimmable design, installers can customize the length of the channel according to the shower layout, resulting in faster and hassle-free installation.



SIMPLIFIED INSTALLATION

REVOLUX comes with detailed instructions and installation videos that will make the work of installers easier.



LONG-LASTING

Revolux is manufactured from 6063 - T6 aircraft grade aluminum, making it a true warrior against corrosion. A channel that withstands the test of time like no other!



DIFFERENT DESIGNS

And for those who value style as much as functionality, we have created 2 different designs with 5 finishes in captivating colors that will create a perfect combination with the faucets and shower area in the bathroom.



HIGH EVACUATION FLOW

And best of all, the flow rate on this designs is tremendously high. Thanks to its shape the water flows straight to the drain at flows higher than 8 gallons per minute when properly installed.

Designer shower shelves made in high quality stainless steel curved. Produced in rectified thickness to fit in tile joint size from 1/32". By its engineered design and materials it has been tested in heavy duty situations and holding weights up to 50 lbs.



**BEAT TRIANGLE
BRUSHED**



**BEAT TRIANGLE
DARK-NERO**



**BEAT TRIANGLE
NICKEL CHAMPAGNE**



**BEAT TRAPEZOID
BRUSHED**



**BEAT TRAPEZOID
DARK-NERO**



**BEAT TRAPEZOID
NICKEL CHAMPAGNE**



**BEAT TRAPEZOID
WHITE**



**BEAT TRAPEZOID
GOLD**



**BEAT TRAPEZOID
POLISHED**



**PLUS TRIANGLE
BRUSHED**



**PLUS TRIANGLE
DARK-NERO**



**PLUS TRIANGLE
NICKEL CHAMPAGNE**



**PLUS TRIANGLE
WHITE**



**PLUS TRAPEZOID
BRUSHED**



**PLUS TRAPEZOID
DARK-NERO**



**PLUS TRAPEZOID
NICKEL CHAMPAGNE**



**PLUS TRAPEZOID
WHITE**



**PLUS TRAPEZOID
ASIM BRUSHED**

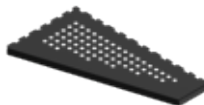

**PLUS TRAPEZOID
ASIM DARK-NERO**



**PLUS TRAPEZOID
ASIM NICKEL
CHAMPAGNE**



**PLUS TRAPEZOID
ASIM WHITE**

REF.	DESCRIPTION	FINISH	MSRP
IZU0004	SHELF BEAT TRIANGLE	BRUSHED	\$ 81.25
IZU0000	SHELF BEAT TRIANGLE	NERO	\$ 81.25
IZU0005	SHELF BEAT TRIANGLE	NICKEL CHAMPAGNE	\$ 100.38
IZU0006	SHELF BEAT TRAPEZOID	BRUSHED	\$ 85.00
IZU0001	SHELF BEAT TRAPEZOID	NERO	\$ 85.00
IZU0008	SHELF BEAT TRAPEZOID	WHITE	\$ 85.00
IZU0007	SHELF BEAT TRAPEZOID	NICKEL CHAMPAGNE	\$ 104.50
IZU0009	SHELF BEAT TRAPEZOID	GOLD	\$ 104.50
IZU0010	SHELF BEAT TRAPEZOID	POLISHED	\$ 104.50

REF.	DESCRIPTION	FINISH	MSRP
IZU0302	SHELF PLUS TRIANGLE	BRUSHED	\$ 81.25
IZU0301	SHELF PLUS TRIANGLE	NERO	\$ 81.25
IZU0300	SHELF PLUS TRIANGLE	WHITE	\$ 81.25
IZU0314	SHELF PLUS TRIANGLE	NICKEL CHAMPAGNE	\$ 100.38
IZU0305	SHELF PLUS TRAPEZOID	BRUSHED	\$ 85.00
IZU0304	SHELF PLUS TRAPEZOID	NERO	\$ 85.00
IZU0303	SHELF PLUS TRAPEZOID	WHITE	\$ 85.00
IZU0312	SHELF PLUS TRAPEZOID	NICKEL CHAMPAGNE	\$ 104.50
IZU0308	SHELF PLUS TRAPEZOID ASIM	BRUSHED	\$ 97.50
IZU0307	SHELF PLUS TRAPEZOID ASIM	NERO	\$ 97.50
IZU0306	SHELF PLUS TRAPEZOID ASIM	WHITE	\$ 97.50
IZU0313	SHELF PLUS TRAPEZOID ASIM	NICKEL CHAMPAGNE	\$ 115.50





SQUARE DRAIN CONNECTOR

Easy to install shower pipe connection either in mud bed installations or presloped system. (*Mud Bed Universal Connector Included*).

1x Subdrain



1x Universal adapter

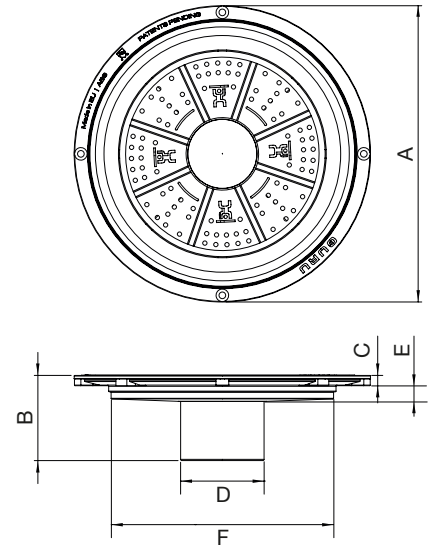

DRAIN MEASUREMENTS

A	9 1/2" - 245 mm
B	2 3/4" - 70,5 mm
C	3/8" - 9,5 mm
D	2 3/4" - 69 mm
E	1/2" - 13 mm
F	7 1/4" - 184 mm

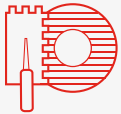

Bonding flange for superior thinset adhesion



Can be installed over existing drain pipe connection



Quickest to install system



Drain repositioning system up to 1/4"

STANDARD DRAIN POSITION

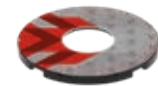

TILEABLE DRAIN POSITION



INSTALLATION HEIGHT OPTIONS

MUD BED SYSTEM

3/4"



1"

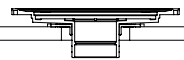

1 1/2"



2"

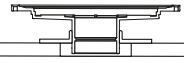

PRESLOPED SYSTEM

OTHER MODELS

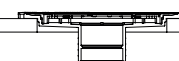

INTEGRA DRAIN

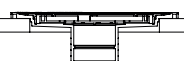

NEW PRODUCT

REF.	DESCRIPTION	MATERIAL	MSRP
IGU6801	SQUARE DRAIN CONNECTOR	ABS (black)	\$ 49.78
IGU6803	SQUARE DRAIN CONNECTOR	PVC (grey)	\$ 49.78





LINEAR DRAIN CONNECTOR

Easy to install shower drain pipe connection either in mud bed installations or presloped system. It's reduced dimensions make it ideal for "close to wall" installations. Ideal for shower with just 1 slope. **(Mud Bed Universal Connector Included).**

1x Subdrain

1x Universal adaptor

1x Height support

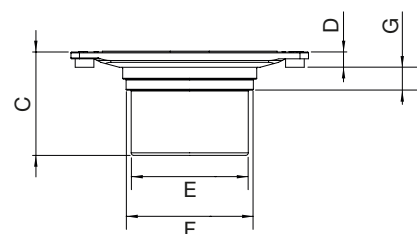
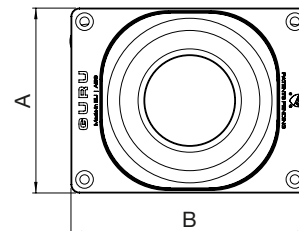

DRAIN MEASUREMENTS

A	4 1/2" - 109 mm
B	5 1/2" - 140 mm
C	2 1/2" - 61 mm
D	3/8" - 9 mm
E	2 3/4" - 69 mm
F	3" - 75 mm
G	3/5" - 15,5 mm

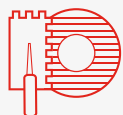

Bonding flange for superior thinset adhesion



Can be installed over existing drain pipe connection



Quickest to install system



Drain repositioning system up to 3/8"

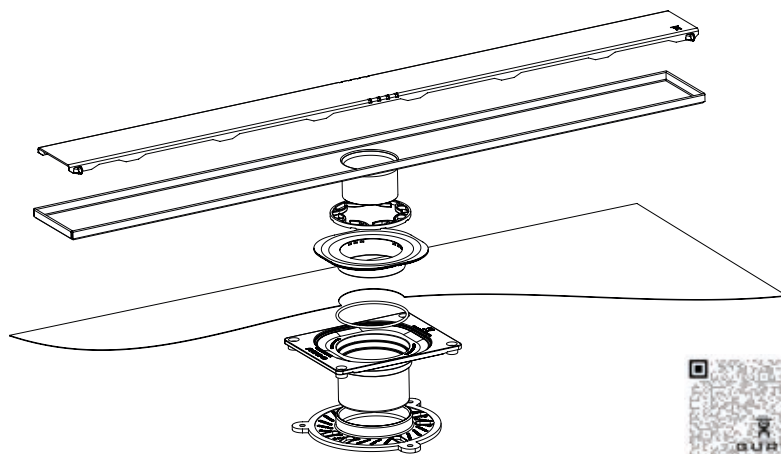

NEW PRODUCT

REF.	DESCRIPTION	MATERIAL	MSRP
IGU6800	LINEAR DRAIN CONNECTOR	ABS (black)	\$ 39.05
IGU6802	LINEAR DRAIN CONNECTOR	PVC (grey)	\$ 39.05

INSTALLATION HEIGHT OPTIONS

MUD BED SYSTEM	
3/4"	1"
1 1/2"	2"
PRESLOPED SYSTEM	
OTHER MODELS	INTEGRA DRAIN



SQUARE DRAIN CONNECTOR KIT

- » This kit can be used either for a mortar bed installation or GURU Heavy Duty Presloped Shower Pan 4 slopes.
- » Adaptor ring included with different preset heights for a mortar bed installation from 3/4" to 2" thickness. It also works as an adaptor for the most common body drains on the market with perforated pattern holes.
- » Horizontal shower drain adjustment allowing 1/4" movement.
- » The most advanced drain body sealant connection.
- » Product developed according to IAPMO PS106.

includes

- | | | |
|---------------------------|----------------------|---------------|
| 1. Square drain connector | 3. Mixing Valve Seal | 5. 4x W-S Dex |
| 2. W-S Sealant | 4. 3/4" Pipe Seal | 6. 4x W-S Din |



REF.	DESCRIPTION	MATERIAL	MSRP
ICU3009	SQUARE DRAIN CONNECTOR KIT	ABS (black)	\$ 145.00
ICU3011	SQUARE DRAIN CONNECTOR KIT	PVC (grey)	\$ 145.00



LINEAR DRAIN CONNECTOR KIT

- » This kit can be used either for a mortar bed installation or GURU Heavy Duty Presloped Shower Pan 2 slopes.
- » Adaptor ring included with different preset heights for a mortar bed installation from 3/4" to 2" thickness. It also works as an adaptor for the most common body drains on the market with perforated pattern holes.
- » Horizontal shower drain adjustment allowing 3/8" movement.
- » The most advanced drain body sealant connection.
- » Product developed according to IAPMO PS106.



includes

- | | | |
|---------------------------|----------------------|---------------|
| 1. Linear drain connector | 3. Mixing Valve Seal | 5. 4x W-S Dex |
| 2. W-S Sealant | 4. 3/4" Pipe Seal | 6. 4x W-S Din |



REF.	DESCRIPTION	MATERIAL	MSRP
ICU3010	LINEAR DRAIN CONNECTOR KIT	ABS (black)	\$ 125.00
ICU3012	LINEAR DRAIN CONNECTOR KIT	PVC (grey)	\$ 125.00

PRESLOPED SHOWER PAN SQUARE



W-S HEAVY DUTY SHOWER TRAY FOR SQUARE DRAINS (4 SLOPES) Heavy Duty Pre-sloped shower pan with 4" overlap. The hardest shower pan in the market, allowing installation of any tile size, including penny tile.

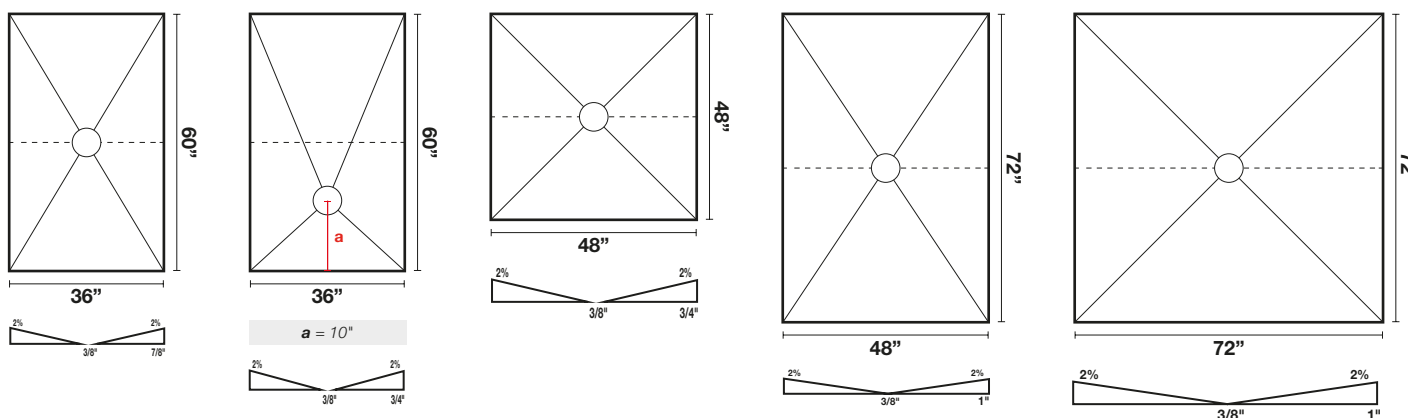

NEW PRODUCT

REF.	DESCRIPTION	SIZE	HEIGHT	DRAIN PLACEMENT	MSRP
IMU9400	W-S HEAVY DUTY SHOWER TRAY	36" x 60"	3/8" to 7/8"	CENTER	\$ 158.73
IMU9404	W-S HEAVY DUTY SHOWER TRAY	36" x 60"	3/8" to 3/4"	OFF-CENTER (10" from wall)	\$ 158.73
IMU9401	W-S HEAVY DUTY SHOWER TRAY	48" x 48"	3/8" to 3/4"	CENTER	\$ 150.69
IMU9402	W-S HEAVY DUTY SHOWER TRAY	48" x 72"	3/8" to 1"	CENTER	\$ 243.39
IMU9403	W-S HEAVY DUTY SHOWER TRAY	72" x 72"	3/8" to 1"	CENTER	\$ 336.97

Developed according to IAPMO PS106. Certified ANSI A118.10 and ANSI A118.12.



Heavy duty



Quickly walkable



Quick installation

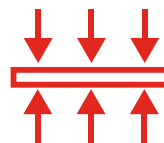

Ultra thin



Easily cuttable
Fit to size



PRESLOPED SHOWER PAN **LINEAR**



W-S HEAVY DUTY SHOWER TRAY FOR LINEAR DRAINS (2 SLOPES) Heavy Duty Pre-sloped shower pan with 4" overlap. The hardest shower pan in the market, allowing installation of any tile size, including penny tile.

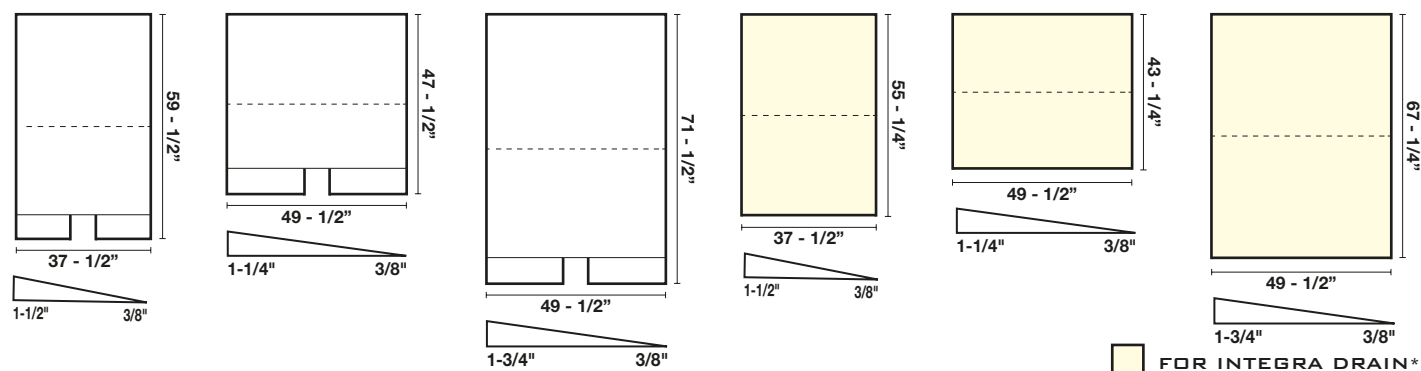

*FOR TILEABLE LINEAR DRAIN AND TILE INSTALLATION THINNER THAN 3/8"

NEW PRODUCT

REF.	DESCRIPTION	SIZE	HEIGHT	DRAIN PLACEMENT	MSRP
IMU9200	W-S HEAVY DUTY SHOWER TRAY	37-1/2" x 59-1/2"	3/8" to 1-1/2"	OFF-CENTER	\$ 287.85
IMU9201	W-S HEAVY DUTY SHOWER TRAY	49-1/2" x 47-1/2"	3/8" to 1-1/4"	OFF-CENTER	\$ 276.41
IMU9202	W-S HEAVY DUTY SHOWER TRAY	49-1/2" x 71-1/2"	3/8" to 1-3/4"	OFF-CENTER	\$ 380.00
IMU9203	W-S HEAVY DUTY INTEGRA SHOWER TRAY	37-1/2" x 55-1/4"	3/8" to 1-1/2"	OFF-CENTER	\$ 287.85
IMU9204	W-S HEAVY DUTY INTEGRA SHOWER TRAY	49-1/2" x 43-1/4"	3/8" to 1-1/4"	OFF-CENTER	\$ 276.41
IMU9205	W-S HEAVY DUTY INTEGRA SHOWER TRAY	49-1/2" x 67-1/4"	3/8" to 1-3/4"	OFF-CENTER	\$ 380.00

Developed according to IAPMO PS106. Certified ANSI A118.10 and ANSI A118.12.



Heavy duty



Quickly walkable



Quick installation

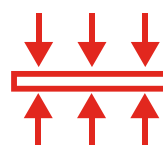

Ultra thin



Easily cuttable
Fit to size



INSTALLATION TRAY FOR SQUARE DRAINS

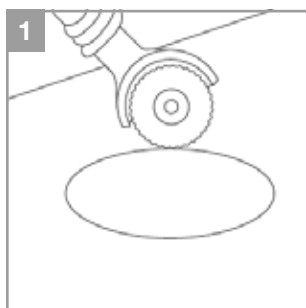

1. Position the tray marking the drain position. Drill a **7 1/2"** hole.

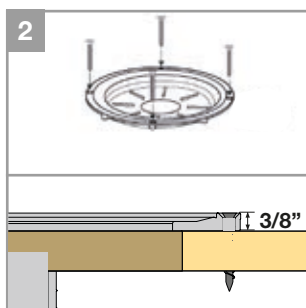

2. Screw the drainbody in the floor with drive head screws non les than 4 mm (T20). **View heights in page 18.**
Note: In concrete installations set the drain levelled with thinset.

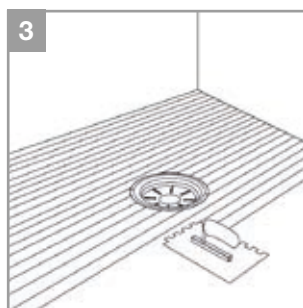

3. Apply thin set cement (tile adhesive) in the drain shower area with 1/4" x 1/4" notched trowel from the shower perimeter to the drain.

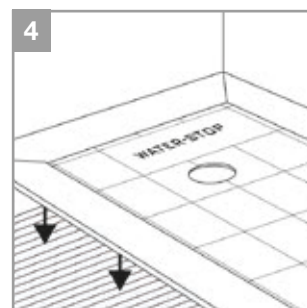

4. Set the W-S HEAVY DUTY SHOWER TRAY in top of the thin set before it cures and apply presure on top of it.

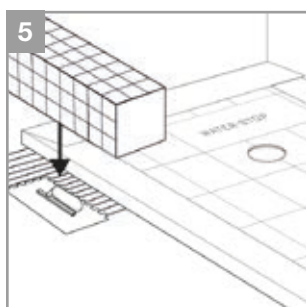

5. Apply thin set cement in shower area perimeter where curb will be installed. Set the curb in top of the thin set before it cures and apply presure on top of it.

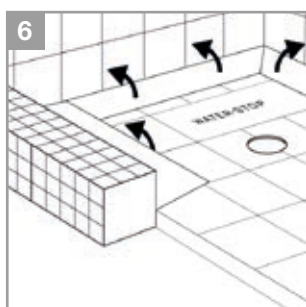

6. Waterproof the walls either with WATER-STOP membrane or W-S BOARD. Connect waterproofing fixing overlapping to walls and curb applying thin set cement between both parts.

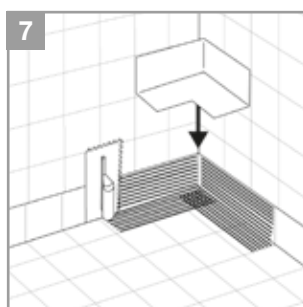

7. Use the preformed W-S Corners to seal the installation laying it and press firmly. Remove any trapped air to guarantee full adhesion by spreading the adhesive from the inside out.

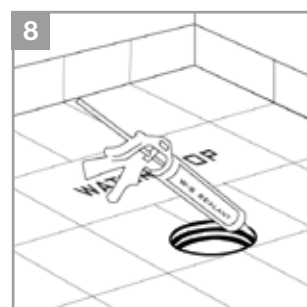

8. Lift the Edge of the WATER-STOP sheet, insert the cannula of the W-S SEALANT and apply a continuous line of W-S SEALANT in the perimeter sealant area.

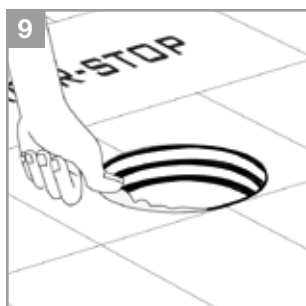

9. Press by hand to distribute the W-S SEALANT and clean the excess material on the edge.

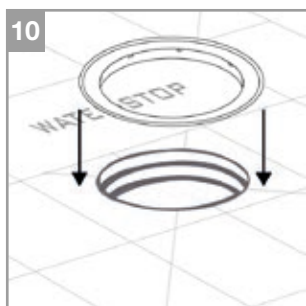

10. Place the bonding flange in top of the drainbody and press it.

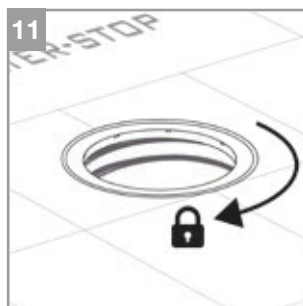

11. Turn it until it is flushed with the shower pan and locked.

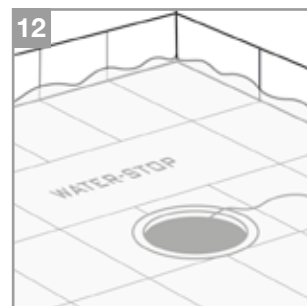

12. Wait one hour before flood test (according to local codes) when using Guru W-S Sealant to install the corners.

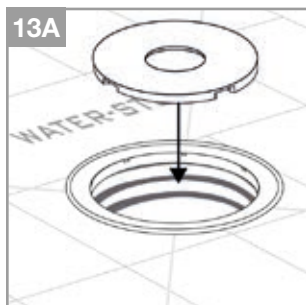

13A. Set the drain receiver in the upright position for standard drain.

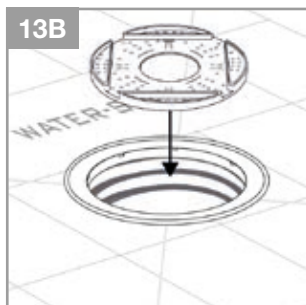

13B. Downward position to receive a tileable drain (INTEGRA) from the lowest height level.



14. Tile on top of the WATER-STOP membrane using the tile required notched trowel.

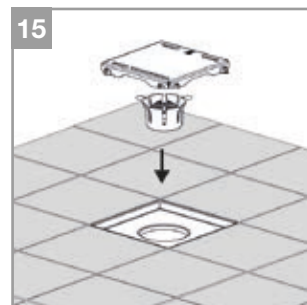

15. Install the tile according to TCNA handbook.

INSTALLATION TRAY FOR LINEAR DRAINS

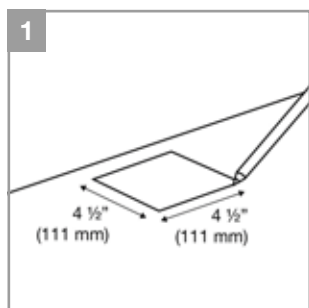

1. Position the tray marking the drain position.

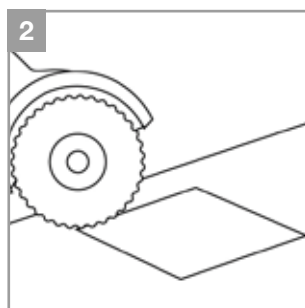

2. Cut a 4-1/2" x 4-1/2" rectangle in the wood.

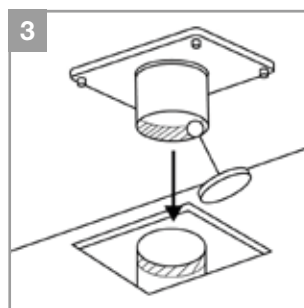

3. Verify the drainpipe is at least at 1-3/8" (33 mm) of the substrate surface. Glue the drain body to the drainpipe using the proper adhesive (ABS – black or PVC – white).

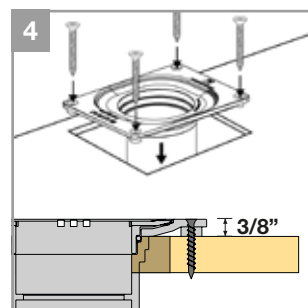

4. Screw the drainbody to the substrate and check the height 3/8".
View heights in page 19.
In concrete installations set the drain levelled with thinset.

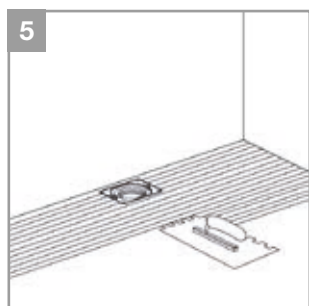

5. Apply thin set cement in the drain shower area with a 1/4" notched trowel from the shower perimeter to the drain. **RECOMMENDED THINSET ANSI A118.4, ANSI A118.11 and ANSI A118.15.**

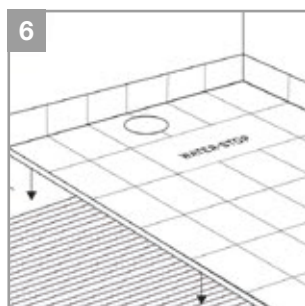

6. Set the SHOWER TRAY in top of the tinset before it cures and apply pressure on top of it.

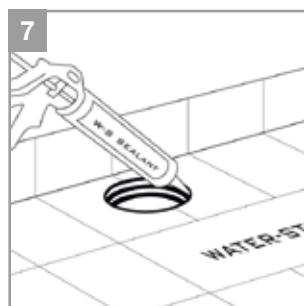

7. Lift the edge of the WATER-STOP sheet, insert the cannula of the W-S Sealant 1/2" and apply a continuous line of mastic in the connection drainbody – WATER-STOP.



8. Press by hand to distribute the W-S Sealant and clean the excess material on the edge.

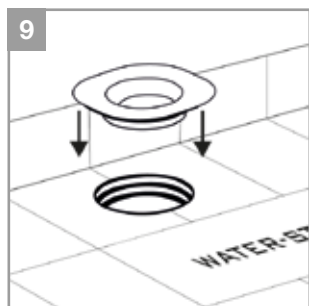

9. Place the bonding flange in top of the drainbody and press until it is lush and locked.

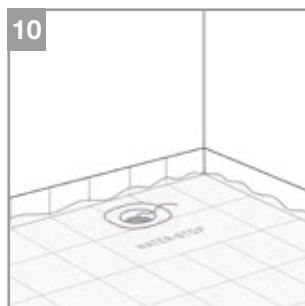

10. Flood test according to local code. If W-S Sealant has been used to install the corners, the test can be performed after 1 hour.



11. Waterproof the walls either with WATER-STOP sheet or W-S Board.



12. Place the height support ring to allow adjustment of the drain height. The height may vary depending on the tile thickness.



13. Tile on top of the HEAVY DUTY SHOWER TRAY using the tile required notched trowel.

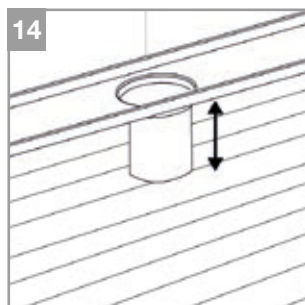

14. Adjust the height of the drain depending on the tile thickness.

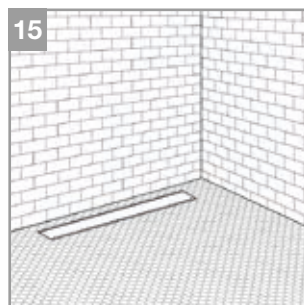

15. Once tiled and grouted add the hair trap and drain strainer.

INTEGRA DRAIN



SCAN THE QR FOR INTEGRA DRAIN INSTALLATION.

KIT FOR MUD BED SHOWER



The evolux kit is the perfect shower system for the mud slope installers that want to have the best results at the lowest cost. Very well packed, easy to carry by hand with all the materials the contractor needs besides the tile, the thin-set and grout.

 includes

1. WATER-STOP waterproofing membrane 6' 7" x 6' 7" (48 sqft)

2. PVC Square Drain Connector

3. 4x W-S DIN preformed in-corner

4. 2x W-S DEX preformed out-corner

5. Mixing Valve Seal



REF.	DESCRIPTION	MSRP
ICU3004	EVOLUX KIT BASE FOR MUDBED SHOWER	\$ 151.27

KIT FOR PRESLOPED SHOWER



Quickest preformed tray with waterproofing factory bonded. It comes with a low profile height shower drain which fits in our push fit clamping ring easily.

REF.	DESCRIPTION	DRAIN	MEASURE	DRAIN PLACEMENT	MSRP
ISU0002	SUPERKIT SQUARE	ABS	36" x 60"	OFF-CENTER	\$ 692.70
ISU0003	SUPERKIT SQUARE	ABS	48" x 48"	CENTER	\$ 641.02
ISU0004	SUPERKIT SQUARE	ABS	36" x 60"	CENTER	\$ 692.70
ISU0005	SUPERKIT SQUARE	ABS	48" x 72"	CENTER	\$ 875.00
ISU0008	SUPERKIT SQUARE	PVC	36" x 60"	OFF-CENTER	\$ 692.70
ISU0009	SUPERKIT SQUARE	PVC	48" x 48"	CENTER	\$ 641.02
ISU0010	SUPERKIT SQUARE	PVC	36" x 60"	CENTER	\$ 692.70
ISU0011	SUPERKIT SQUARE	PVC	48" x 72"	CENTER	\$ 875.00
ISU0023	SUPERKIT SQUARE	PVC	72" x 72"	CENTER	\$ 968.58



REF.	DESCRIPTION	DRAIN	MEASURE	DRAIN PLACEMENT	MSRP
ISU0013	SUPERKIT SQUARE WITHOUT DRAIN	ABS	36" x 60"	OFF-CENTER	\$ 602.70
ISU0016	SUPERKIT SQUARE WITHOUT DRAIN	ABS	48" x 48"	CENTER	\$ 551.02
ISU0012	SUPERKIT SQUARE WITHOUT DRAIN	ABS	36" x 60"	CENTER	\$ 602.70
ISU0018	SUPERKIT SQUARE WITHOUT DRAIN	ABS	48" x 72"	CENTER	\$ 785.00
ISU0014	SUPERKIT SQUARE WITHOUT DRAIN	PVC	36" x 60"	OFF-CENTER	\$ 602.70
ISU0017	SUPERKIT SQUARE WITHOUT DRAIN	PVC	48" x 48"	CENTER	\$ 551.02
ISU0015	SUPERKIT SQUARE WITHOUT DRAIN	PVC	36" x 60"	CENTER	\$ 602.70
ISU0019	SUPERKIT SQUARE WITHOUT DRAIN	PVC	48" x 72"	CENTER	\$ 785.00
ISU0024	SUPERKIT SQUARE WITHOUT DRAIN	PVC	72" x 72"	CENTER	\$ 878.58

 Tray included

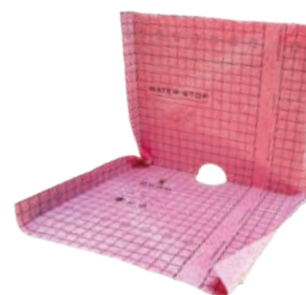

 also includes



36" / 48" Waterproofed Curb

IMU9018 / IMU9019



2x WATER-STOP 3' 3" x 16' 5" Roll
or
1x WATER-STOP 3' 3" x 32' 10" Roll

2x IFU5100 / 1x IFU5113

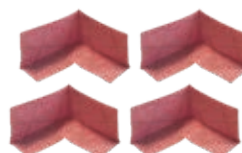

4x W-S DIN

IGU6006

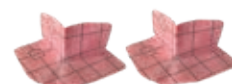

2x W-S DEX

IGU6005



Evo Lite Plus Brushed

IDU7011



Hair Strainer

IP01118



MIXING Valve Seal

IGU6007



3/4" W-S Pipe Seal

IGU6004



W-S Sealant

IGU6400



Square Drain Connector

IGU6801 (ABS) / IGU6803 (PVC)

WATER-STOP WATERPROOFING MEMBRANE



Waterproofing and standard crack isolation membrane. WATER-STOP meets and exceed the requirements of: **ANSI A118.10 (IAPMO FILE 9205) and ANSI A118.12 (IAPMO FILE 9990).**

Product accepted by IAPMO.

NEW PRINTING PATTERN

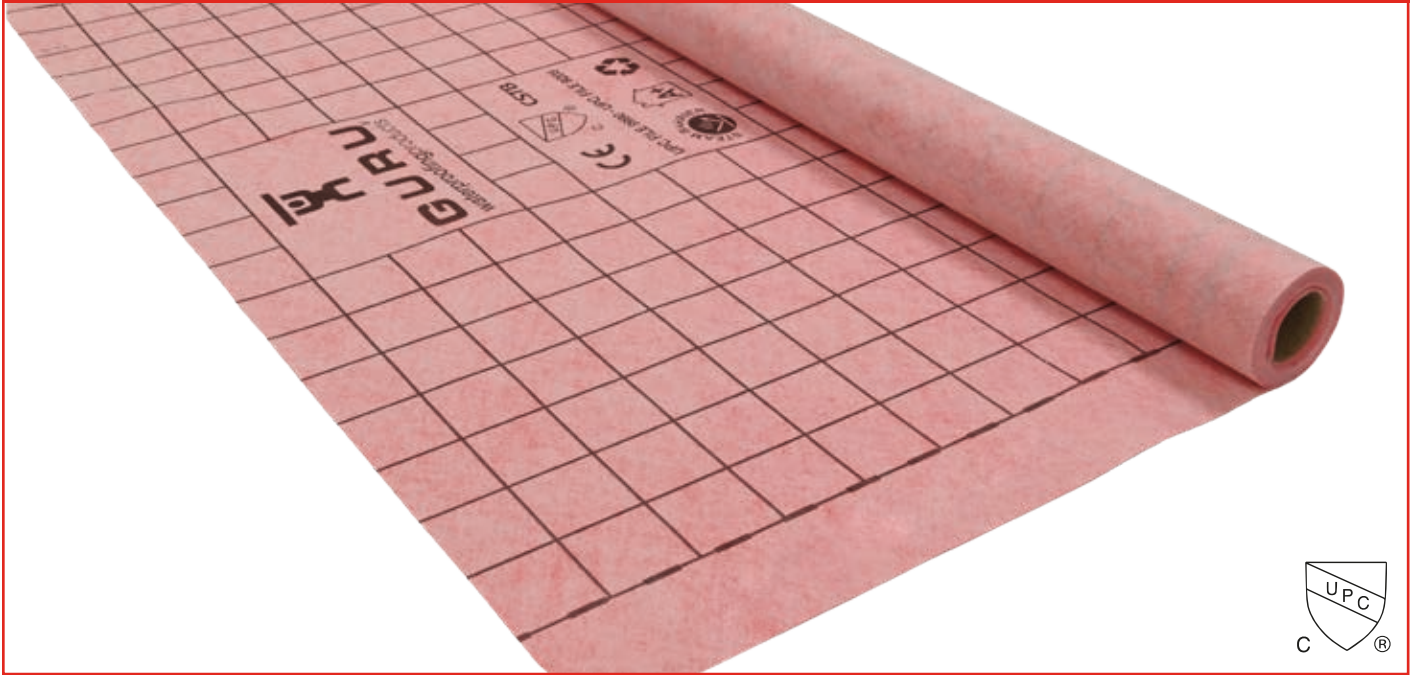

Easy
adhesion



Support
adaptability

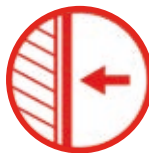

Vertical
fastening



Large
formats



Minimum
installation
height

WATER-STOP is a **highly-flexible**, low perm multi-layer steam barrier sheet membrane 20-mil thick for bonded waterproofing applications. It is suitable to be used in conjunction with ceramic and stone tile covering for wall and floor surfaces, interior and exterior, where protection against the penetration of moisture is necessary in **new construction and renovation projects**. As a **crack isolation membrane** WATER-STOP protects ceramic tile and natural stone from limited in-plane cracks and movement. Also **ideal for use in steam showers as per its low perm rating**.

Applications include showers walls, tub surrounds, bathrooms, steam showers, commercial and residential kitchens, backsplashes areas surrounding swimming pools, balconies, etc.

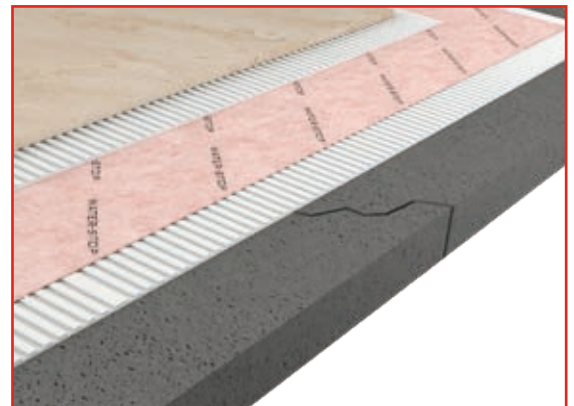



REF.	DESCRIPTION	MEASURE	MSRP/SQFT	MSRP
IFU5502	WATER-STOP PRE-CUT	4' x 6' 7" = 26 sqft	\$ 2.24/sqft	\$ 58.25
IFU5501	WATER-STOP PRE-CUT	5' x 6' 7" = 32 sqft	\$ 1.94/sqft	\$ 62.00
IFU5503	WATER-STOP PRE-CUT	6' 7" x 6' 7" = 43 sqft	\$ 1.65/sqft	\$ 71.08
IFU5100	WATER-STOP ROLL	3' 3" x 16' 5" = 54 sqft	\$ 2.08/sqft	\$ 112.69
IFU5113	WATER-STOP ROLL	3' 3" x 32' 10" = 108 sqft	\$ 2.05/sqft	\$ 221.75
IFU5200	WATER-STOP ROLL	3' 3" x 98' 5" = 323 sqft	\$ 1.93/sqft	\$ 624.10
IFU5300	WATER-STOP ROLL	6' 7" x 65' 7" = 430 sqft	\$ 1.89/sqft	\$ 810.98

FORMATS

A / 4' x 6' 7" = 26 sqft

B / 5' x 6' 7" = 32 sqft

C / 6' 7" x 6' 7" = 43 sqft

D / 3' 3" x 16' 5" = 54 sqft

E / 3' 3" x 32' 10" = 108 sqft

F / 3' 3" x 98' 5" = 323 sqft

G / 6' 7" x 65' 7" = 430 sqft

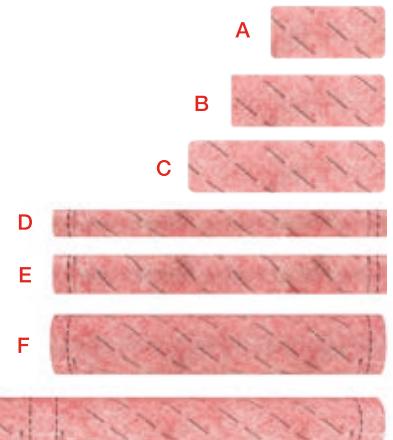

W-S BOARD FOR WALLS



Lightweight construction board made of a XPS core factory bonded in both sides to WATER-STOP membrane exceeding the core dimension - creating a WATER-STOP flange.

Developed according to IAPMO PS106 for tileable kit. Certified **ANSI A118.10** and **ANSI A118.12**.



- No banding required, except for steam shower
- Superior pull-out performance
- Reduces the building time
- It requires a 1/2" width of W-S SEALANT on each side.



NEW PRODUCT

REF.	DESCRIPTION	MEASURE	MSRP
IMU9300	W-S BOARD	3' x 5' x 1/2"	\$ 48.60
IMU9301	W-S BOARD	4' x 8' x 1/2"	\$ 123.87
IMU9310	W-S BOARD	3' x 5' x 1/2" - Pre cut at 3' x 2.5'	\$ 53.24
IMU9700	W-S BOARD	2' x 8' x 2"	\$ 91.82
IMU9710	W-S BOARD	2' x 4' x 2"	\$ 45.91

NEW PRODUCT

REF.	DESCRIPTION	QUANTITY	MSRP
IGU6018	SCREW & WASHER SET	100 UNITS EACH	\$ 24.89
IGU6019	THREADED SCREW FOR STUD FRAMING T-20	200 UNITS	\$ 15.83
IGU6026	GALVANIZED WASHERS	200 UNITS	\$ 24.95

W-S NICHE



Shower niche manufactured with a pre-sloped base and made of a XPS core factory bonded in both sides to WATER-STOP.

- Presloped base
- Full tile size
- Superior thinset spread
- The niches measurements correspond to the interior part, no need to cut standard ceramic tiles sizes.
- 1" Interior Shelf to maximize useful space
- 1.5% presloped



NEW PRODUCT

REF.	DESCRIPTION	MEASURE	INTERIOR SHELF	MSRP
IMU5000	W-S NICHE	12" x 12"	NOT INCLUDED	\$ 67.11
IMU5001	W-S NICHE	12" x 20"	INCLUDED	\$ 90.71
IMU5002	W-S NICHE	12" x 24"	INCLUDED	\$ 98.11
IMU5003	W-S NICHE	12" x 28"	INCLUDED	\$ 108.40

G-FLEX UNCOUPLING MEMBRANE



Waterproofing and **extra heavy duty** crack isolation membrane. G-FLEX meets and exceed the requirements of: **ANSI A118.10 (IAPMO FILE 9205) and ANSI A118.12 (IAPMO FILE 9990).**
Product accepted by IAPMO.

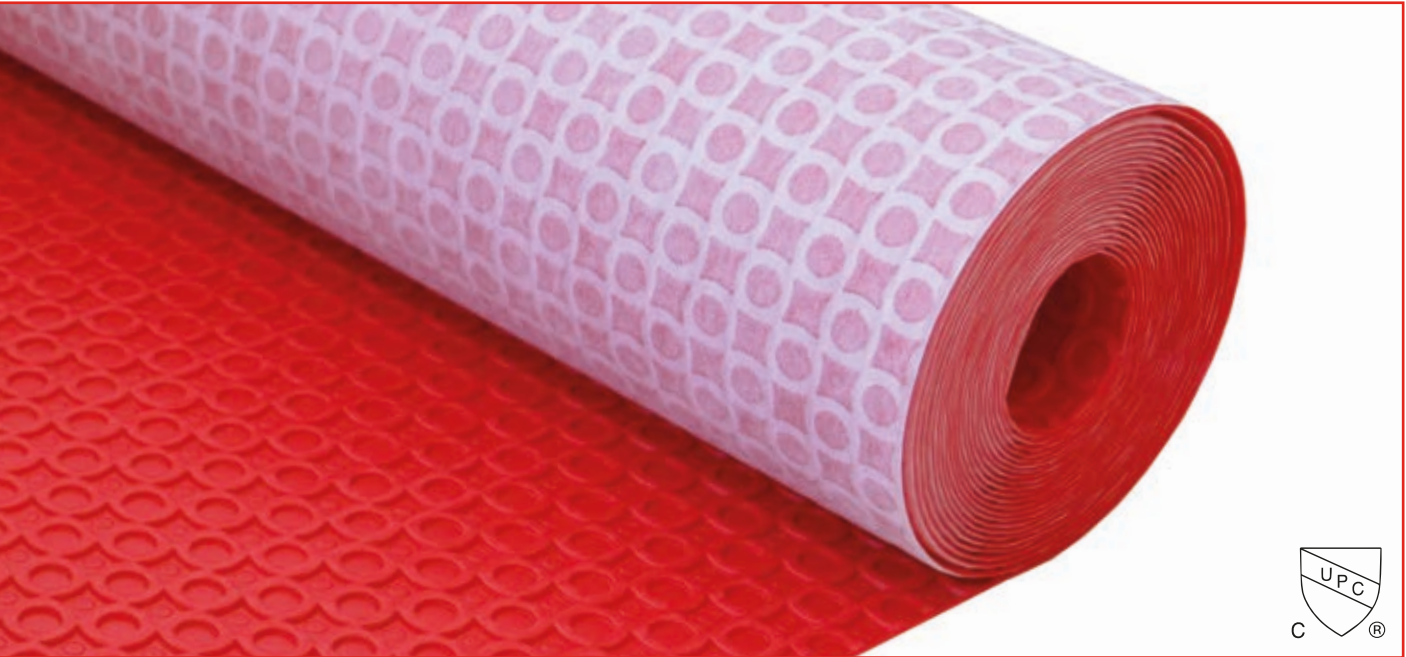

REF.	DESCRIPTION	MEASURE	MSRP/M²	MSRP/ROLL
ILU5100	G-FLEX ROLL	3' 3" x 45' 9" = 150 sqft	\$ 1.96/sqft	\$ 294.84
ILU5200	G-FLEX ROLL	3' 3" x 98' 5" = 323 sqft	\$ 1.84/sqft	\$ 596.32

G-Flex by Guru is a polyethylene membrane with a raised circular pattern. The back of the membrane is covered by a geotextile fiber. Acts as a **waterproofing** membrane, **compensates vapor pressure** if moisture appear on the substrate and a uncoupling membrane on critical substrates. We leave the different uses of the membrane: Food plants, dairies, breweries, airports, kitchens...



Uncoupling



Waterproofing



Vapor pressure compensation



Load distribution



Heat distribution

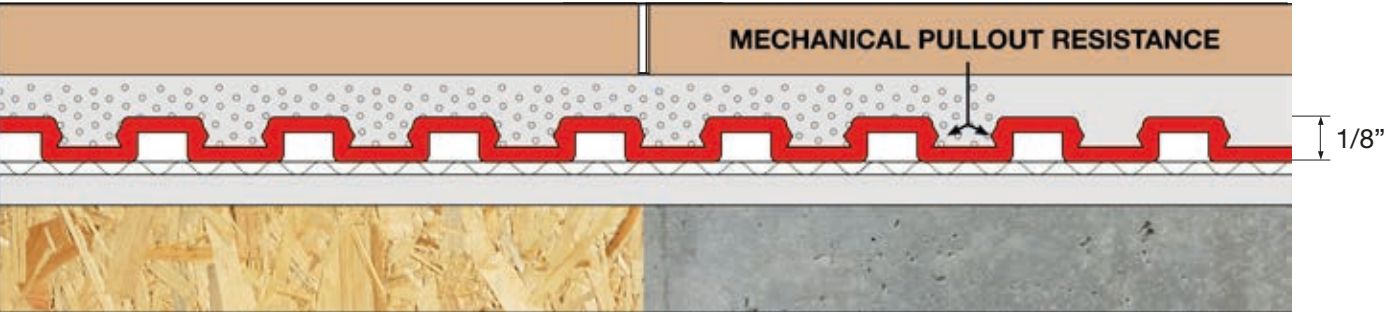

WATER-STOP ACCESSORIES



Reinforcements to complete safely the waterproofing. Waterproofing and crack isolation membrane in accordance with the standards: **ANSI A118.10 and ANSI A118.12**. Product accepted by IAPMO

REF.	DESCRIPTION	MSRP
IGU6004	¾" PIPE SEAL · To seal around inlet and outlet pipes	\$ 9.55
IGU6005	W-S DEX · For exterior corners reinforcement	\$ 19.21
IGU6006	W-S DIN · For interior corners reinforcement	\$ 19.21

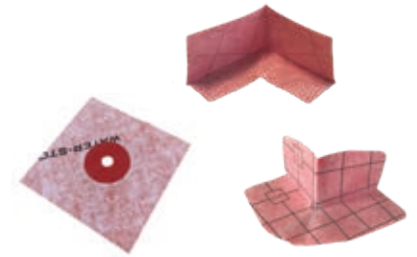

REF.	DESCRIPTION	MSRP
IGU6016	DRAIN FLASHING SET · Preformed membrane of 16" and 1/2" to 1-3/4" high adapter to flashing connection to drain.	\$ 38.00
IGU6007	MIXING VALVE SEAL · Membrane section with 4 - 1/2" diameter integrated rubber gasket to mixing valve seal.	\$ 10.90



REF.	DESCRIPTION	MSRP
IGU6100	ROLL 6" x 65' 7" (14 cm x 20 m) · 6 inched width is perfect for sealing joints as a backing strip It is also recommended for use with liquid waterproofing systems for reinforcing floor to wall joints.	\$ 58.30
IGU6200	ROLL 1' 1" x 65' 7" (34 cm x 20 m) · Its width is great for sealing floor to wall joints in waterproofing terraces and balconies.	\$ 133.16



REF.	DESCRIPTION	MSRP
IGU6400	W-S SEALANT · Sealant adhesive to seal WATER-STOP products and its complementary drains	\$ 28.19
IGU6024	EASEAL 3 kg · Polymer-modified mortar (PCC) monocomponent. Elastic and flexible waterproofing.	\$ 46.50



WATER-STOP ACCESSORIES



Reinforcements to complete safely the waterproofing. Waterproofing and crack isolation membrane in accordance with the standards: **ANSI A118.10 and ANSI A118.12**. Product accepted by IAPMO

REF.	DESCRIPTION	MSRP
IGU6500	PACK ABS DRAIN BODY EVOLUX · ABS Drain body + Two pieces Clamping ring + Weep hole protector	\$ 31.50
IGU6501	PACK ABS DRAIN BODY SUPERKIT · ABS Drain body + One piece Clamping ring + Weep hole protector	\$ 30.00



REF.	DESCRIPTION	MSRP
IGU6700	PACK CAST IRON BODY EVOLUX · CAST IRON Drain body + Two pieces Clamping ring + Weep hole protector	\$ 61.50
IGU6701	PACK CAST IRON BODY SUPERKIT · CAST IRON Drain body + One piece Clamping ring + Weep hole protector	\$ 60.00



REF.	DESCRIPTION	SIZE	MSRP (piece)	MSRP (box)
600003	G-TROWEL · Golden Stainless Steel notched ergonomic trowel	1/8" x 1/8"	\$ 12.95	\$ 77.70 (6 pieces)
600045	G-TROWEL · Golden Stainless Steel notched ergonomic trowel	11/64" x 11/64"	\$ 12.95	\$ 77.70 (6 pieces)
600006	G-TROWEL · Golden Stainless Steel notched ergonomic trowel	1/4" x 1/4"	\$ 12.95	\$ 77.70 (6 pieces)



REF.	DESCRIPTION	SIZE	MSRP
IMU9018	W-S CURB 36" (2 pcs)	4 1/2" X 36"	\$ 93.60
IMU9019	W-S CURB 48"	4 1/2" X 48"	\$ 62.40
IMU9020	W-S CURB 60"	4 1/2" X 60"	\$ 113.97
IMU9022	W-S RAMP (2 pcs)	36" X 12"	\$ 56.00





Faster tile installation with top results with XPro Tools.

REF.	DESCRIPTION	MEASURE	PACKAGING	QUANTITY	MSRP
164500	CLIP	1/64"	BAG	500	\$ 45.40
132500	CLIP	1/32"	BAG	500	\$ 45.40
401650	CLIP	1/16"	BAG	500	\$ 42.50
400850	CLIP	1/8"	BAG	500	\$ 44.00
531650	CLIP	3/16"	BAG	500	\$ 49.00



- **Heavy Duty** Wedge
Cuña resistente
- **High Performance** Injected Plastic
Plástico inyectado de alto rendimiento
- **Slim Base** to avoid air under the tile
Base delgada para evitar el aire bajo la baldosa
- **Colored pliers head** for easier installation
Cabezal de alicates de colores para facilitar la instalación

HOW MANY PIECES DO YOU NEED?



SQ.FT	inch	12 x 12"	18 x 18"	20 x 20"	24 x 24"	32 x 32"	48 x 48"	6 x 24"
		4	2	1	2	1	1	4
		6 x 36"	12 x 36"	12 x 48"	18 x 36"	24 x 12"	40 x 20"	48 x 24"
		4	3	2	1	3	1	1



LEVELING SYSTEMS XPRO



REF.	DESCRIPTION	PACKAGING	QUANTITY	MSRP
200250	WEDGE	BAG	250	\$ 30.30



REF.	DESCRIPTION	PACKAGING	QUANTITY	MSRP
101020	PLIERS	BAG	1	\$ 23.60



NEW PRODUCT

REF.	DESCRIPTION	PACKAGING	QUANTITY	MSRP
600100	CAP	BAG	100	\$ 25.61
600018	1/8 SPACER SPIN	BAG	250	\$ 22.00
600116	1/16 SPACER SPIN	BAG	250	\$ 22.00
600132	1/32 SPACER SPIN	BAG	250	\$ 22.00





GURU USA POSTER



Printed poster, 5 models available.
SIZE (inches): 28 x 71 wide x height
\$ 50.00

POS DISPLAY

POS display (point of sales) is the perfect way to present and explain our products. It displays each one of our designs to claim client attraction.

SIZE (inches): 40 x 75.75 x 15.75 wide x height x depth

\$ 250.00
*Price for the display only



REF.	DESCRIPTION	MSRP
MK00019	WATER-STOP POS DISPLAY WITH GURU VINYL	\$ 250.00
MK00020	SHOWER SYSTEMS POS DISPLAY WITH GURU VINYL	\$ 250.00
MK00021	WATER-STOP POS DISPLAY - METERING WITH GURU VINYL	\$ 250.00
MK00022	SHOWER SYSTEMS POS DISPLAY - METERING WITH GURU VINYL	\$ 250.00

DISPLAYS



XPRO EXPOSITOR

POS display (point of sales) is the perfect way to present and explain our products.

SIZE (inches): 40 x 75.75 x 15.75 wide x height x depth



Cardboard container display. It contains 11 bags of different products that the customer can choose from.

SIZE (inches): 18.5 x 68 x 13.75 wide x height x depth



POS DISPLAY

POS display (point of sales) is the perfect way to present and explain our products.

SIZE (inches): 25 x 75 x 17.75 wide x height x depth



REF.	DESCRIPTION	MSRP*
MK00055	XPRO POS DISPLAY	\$ 250.00
IP01347	XPRO CARDBOARD CONTAINER DISPLAY	\$ 100.00

*Price for the display only

REF.	DESCRIPTION	MSRP*
MK00018	SHELF TOWER DISPLAY	\$ 250.00

*Price for the display only

SHOWER DRAINS AND SHELVES

Shower drains and shelves quadriptych to show our astonishing finishes.

SIZE (inches): 12 x 16.5 x 2 wide x height x depth



REF.	DESCRIPTION	MSRP
MKU0004	SHOWER SYSTEM FINISHES QUADRIPTYCH	\$ 200.00

*Price for the display only

REAL SQUARE DRAINS DISPLAY

It has real shower drains to show our astonishing finishes.

INCLUDES: - 4 1/2" shower drain models.

SIZE (inches): 39.7 x 35,43 x 0.78 wide x height x depth



REF.	DESCRIPTION	MSRP
IPU0017	REAL SQUARE DRAINS DISPLAY	\$ 400.00

*Price for the display only



GURU USA, L.L.C.

10301 NW 108TH AVE, SUITE 6

MEDLEY, FL 33178

Ph.: +1 800-596-7885

help@guru-usa.com

www.guru-usa.com

